

ONLEVEL

Installing wooden handrail on glass balustrade

- Needed – Wood constructor or carpenter specialist
- Needed - Machine: cutting/connection parts

Step 1 Check the size of the glass and level them out properly

8/8 (17.52mm) or 10/10 (21.52mm)



Step 2 Select the shape of the wood

- rectagle or round

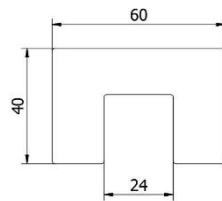

Select the type of wood: oak, essen or berk

Step 3 select mounting type Gasket or Glue



3.1 Using a standard gasket U24 - (8/8) = 90.6542.016.60 or (10/10) 90.6542.020.60 – follow procedure

3.2 Put the gasket on the glass



3.3 Put the gasket on the corners



3.4 Put the handrail on the gasket



ONLEVEL

3.5 Install corner pcs



3.6 connect corner pcs to straight pcs (can be connect by carpenter/wood worker)



3.7 Mount the end-caps with glue for wood



3.8 Hammer the end cap in the handrail

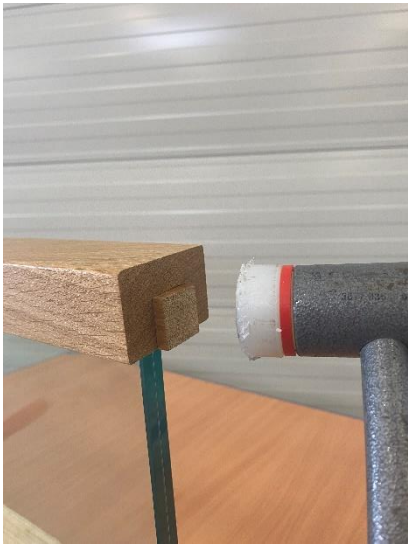

ONLEVEL

4.0 Using silicon – Recommend (pvb foil resistance)

<https://industry.sika.com/en/home/building-components/facade/glass-balustrades.html>

Very important!!

Important is here, that the groove of the handrailing need to be adjusted to the glass thickness.

Example: Glass 8/8/2 (16,76mm) Groove: 16,8mm

This shows that you can't use our standard hand railings

4.1 Put the silicon on the glass



4.2 Put the handrail on the glass

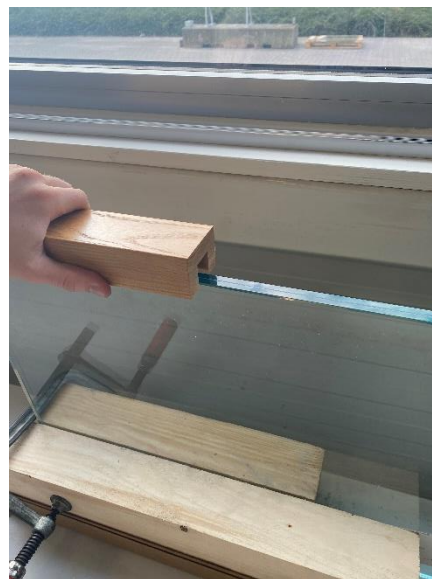

ONLEVEL

4.3 Install the corner pcs



4.4 straight part fixt to corner pcs



ONLEVEL

5.0 FAQ

5.1 Test the uniformity of the glass height.

5.2 Start at the highest point.

5.3 Consider using connecting pins if required to secure uniform lining

End result



ONLEVEL

